

Cylindrical measuring inserts for indicators.

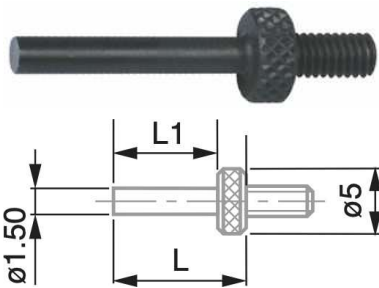

Steel

MSA	Ø	Useful length	Kg
15.477	2.00 mm	5.00 mm	0.001
15.417	2.00 mm	10.00 mm	0.001
15.416	2.00 mm	15.00 mm	0.001

Steel cylindrical measuring insert with flat measuring face, M2.5.

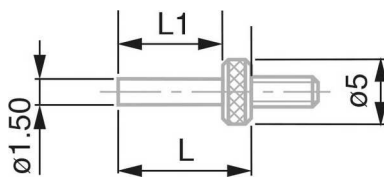

Steel

MSA	Ø	Useful length	Kg
15.650	1.50 mm	15.00 mm	0.004
15.651	1.50 mm	20.00 mm	0.004
15.652	1.50 mm	25.00 mm	0.004
15.653	1.50 mm	30.00 mm	0.004

Steel cylindrical measuring insert with flat measuring face, M2.5.

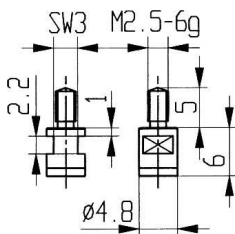

Carbide

MSA	Ø	Useful length	Kg
15.654	4.80 mm	6.00 mm	0.004

Carbide cylindrical measuring insert with flat measuring face, M2.5.

Special measuring inserts for indicators.

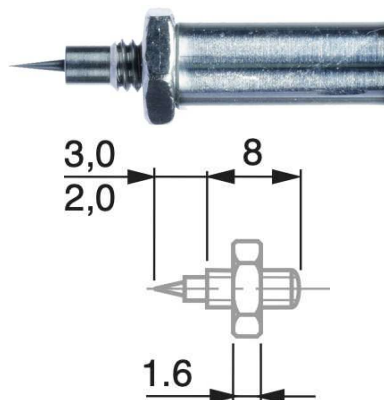

Steel

MSA	Kg
15.448	-

Steel measuring insert with needle contact point, M2.5.

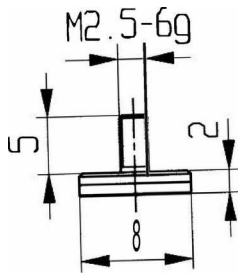

Steel

MSA	Ø	Thickness	Useful length	Kg
15.657-08	8.00 mm	2.00 mm	7.00 mm	0.010
15.657-10	10.00 mm	2.00 mm	7.00 mm	0.010
15.657-12	12.00 mm	2.00 mm	7.00 mm	0.010
15.657-15	15.00 mm	2.00 mm	7.00 mm	0.010
15.657-20	20.00 mm	2.00 mm	7.00 mm	0.010
15.657-25	25.00 mm	2.00 mm	7.00 mm	0.010

Steel measuring insert plate-shaped, M2.5.

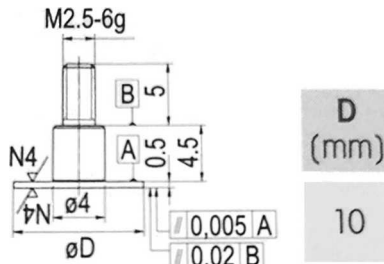

Steel

MSA	Ø	Thickness	Kg
15.668	10.00 mm	0.50 mm	0.002

Steel measuring insert plate-shaped, M2.5.

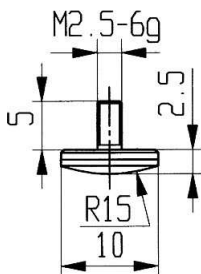

Carbide

MSA	Ø	Thickness	Useful length	Kg
15.658	10.00 mm	2.50 mm	7.50 mm	0.002

Carbide domed measuring insert, M2.5.

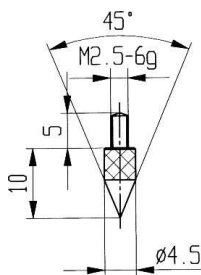

Carbide

MSA	Ø	Useful length	Kg
15.659	4.50 mm	10.00 mm	0.002

Carbide conical 45° measuring insert, M2.5.

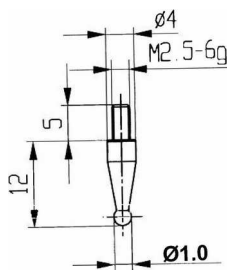

Carbide

MSA	Ø	Useful length	Kg
15.660-1.00	1.00 mm	12.00 mm	0.004
15.660-2.00	2.00 mm	12.00 mm	0.004
15.660-3.00	3.00 mm	12.00 mm	0.004

Carbide ball tip measuring insert, M2.5.

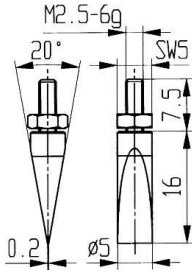

Carbide

MSA	Ø	Useful length	Kg
15.661	5.00 mm	16.00 mm	0.005

Carbide knife-shaped 20° measuring insert, M2.5.

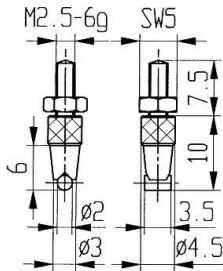

Carbide

MSA	Ø	Useful length	Width	Kg
15.662	2.00 mm	10.00 mm	3.50 mm	0.005

Carbide over wire measuring insert, M2.5.

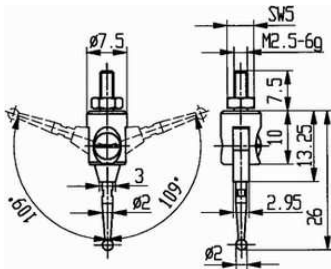

Carbide

MSA	Ø	Useful length	Kg
15.663	2.00 mm	26 mm	0.005

Carbide ball tip measuring insert on articulated pivot, M2.5.

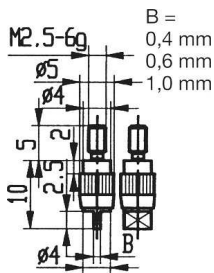

Carbide

MSA	Thickness	Useful length	Width	Kg
15.664	0.40 mm	2.50 mm	2.00 mm	0.005
15.665	0.60 mm	2.50 mm	2.00 mm	0.005
15.666	1.00 mm	2.50 mm	4.00 mm	0.005

Carbide knife-shaped measuring insert, M2.5.

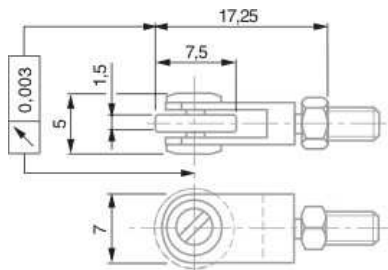

Steel

MSA	Ø	Useful length	Kg
15.667	7.00 mm	17.25 mm	0.005

Steel measuring insert with ball-bearing rollers.

Adapter for vertical dial indicators.

SWISSMETROLOGIE



MSA	Size	Kg
15.380	Ø 8 x 35 mm	0.010

Adapter for mounting on a vertical dial indicator. To be used with a plug gauge.

Adapter for interchangeable cylindrical measuring inserts for indicators.

SWISSMETROLOGIE



MSA	Kg
15.373	0.002

Adapter for steel interchangeable cylindrical measuring inserts, clamping shank Ø 1.50 mm with tightening screw.

Spare part :

MSA	Item	Kg
15.373-V	Tightening screw	0.001

Interchangeable measuring inserts for indicators.

SWISSMETROLOGIE

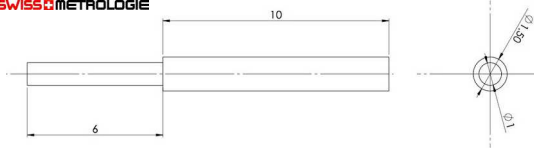

Carbide

MSA	Ø	Useful length	Total length	Kg
15.358-0.20	0.20 mm	4 mm	16 mm	0.001
15.358-0.30	0.30 mm	4 mm	16 mm	0.001
15.358-0.40	0.40 mm	4 mm	16 mm	0.001
15.358-0.50	0.50 mm	4 mm	16 mm	0.001
15.358-0.80	0.80 mm	6 mm	16 mm	0.001
15.358-1.00	1.00 mm	6 mm	16 mm	0.001
15.358-1.20	1.20 mm	6 mm	16 mm	0.001
15.358-1.50	1.50 mm	16 mm	16 mm	0.001
15.358-2.00	2.00 mm	10 mm	16 mm	0.001

Carbide interchangeable cylindrical measuring insert with flat measuring face.

SWISSMETROLOGIE

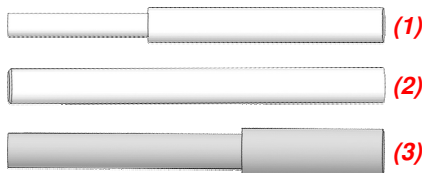

PEEK

MSA	Ø	Useful length	Total length	Kg
15.357-1.00 (1)	1.00 mm	10 mm	16 mm	0.001
15.357-1.50 (2)	1.50 mm	16 mm	16 mm	0.001
15.357-2.00 (3)	2.00 mm	6 mm	16 mm	0.001

PEEK interchangeable cylindrical measuring insert with flat measuring face.

Extensions for measuring inserts.

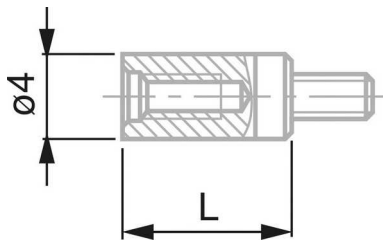

MSA	Ø	Length	Kg
15.359-07	4.00 mm	7 mm	0.001
15.359-10	4.00 mm	10 mm	0.002
15.359-15	4.00 mm	15 mm	0.002
15.359-20	4.00 mm	20 mm	0.003
15.359-25	4.00 mm	25 mm	0.004
15.359-30	4.00 mm	30 mm	0.004
15.359-40	4.00 mm	40 mm	0.005
15.359-50	4.00 mm	50 mm	0.006

Extension for measuring inserts, M2.5.