



MSA	Version	Voltage	Size	Kg
19.850	Up to 10 benches	220 V	500 x 700 x 800 mm	100.000

AIRcenter is a system which combines air pressure and vacuum in 1 machine adapted to final watch assembling as well as the after sales service using small and medium quantity of air. All-in-one concept, which doesn't require fixed air main masonry and electricity settlement. Flexible and easy to move wherever in the watch shop.

Bench air supply is made with soft pipes and individual pedal for each work place. Oil free motor which gives high air quality. It functions without using any pedals.

Technical data :

- Air pressure max. : 8 bar
- Vacuum : 800 mbar
- Air tank volume : 16 litres
- Vacuum tank volume : 40 litres
- Noise level : 50 dB
- Connections : 2x AC and 1x vacuum.

Delivered with air drier MSA19.850-02 (8) and recovery bowl MSA19.850-01.

(8) Accessories : see following pages.

This machine is only available on the Swiss market.

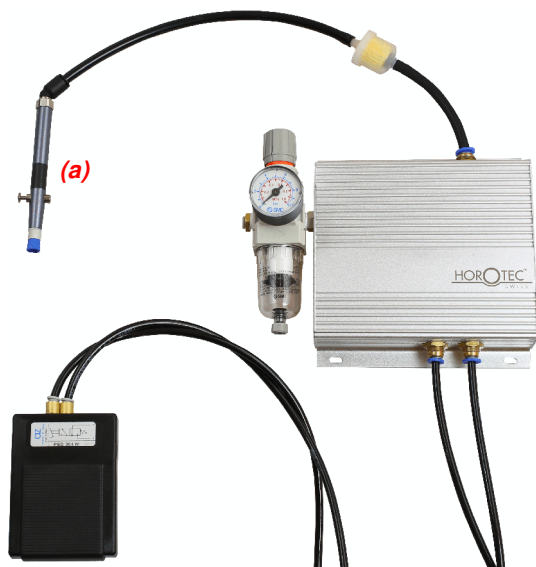

MSA	Version	Size	Kg
19.875	1 work station	160 x 220 x 85 mm	1.700

Air flow/vacuum device for 1 work station.

This device requires a compressor to operate.

The integrated Venturi system transforms the forced air in vacuum.

Delivered with :

- 1 pedal MSA19.875-B
- 1 filter MSA19.875-A
- 1 hose Ø 6x4 mm MSA19.826, length 3 metres
- 1 hose Ø 8x5.5 mm MSA19.851, length 3 metres
- 1 transparent hose Ø 10x6 mm MSA19.812, length 3 metres.

Accessories :

MSA	Item	Kg
19.875-A	Filter	0.004
19.875-B	Pedal	0.200
19.875-C	Male manometer 1/8 Transair	0.035

See following pages for other accessories.

(a) Vacuum pencil not included in delivery



MSA	Version	Voltage	Size	Kg
19.808	2 work stations	220 V	295 x 200 x 220 mm	8.300
19.808-110	2 work stations	110 V	295 x 200 x 220 mm	8.300

System with vacuum. Oil free engine, very noise-less and compatible for use in a white room.

Technical data :
- Flow 2300 litres/hour
- Absolute empty value : 80 mbar
- Pressure 1 bar uninterrupted (maximum 2.8 bar)
- Noise level : 48 dB.

VACUUM FUNCTION

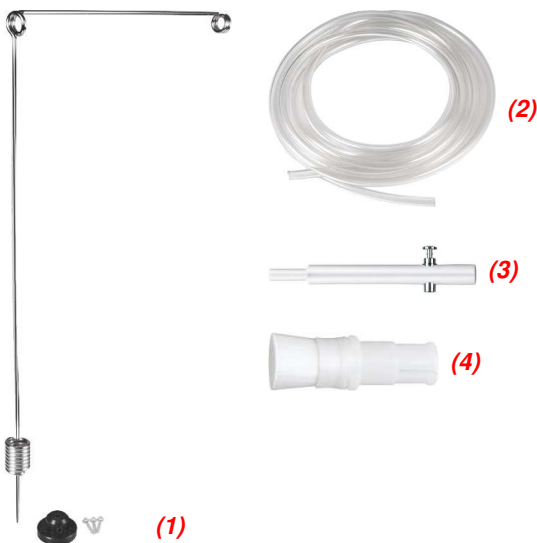

Items delivered with MSA19.808 :

MSA	Item	Kg
19.811	(3) Vacuum pencil (2x)	0.011
19.812	(2) Transparent PVC hose, Ø int. 6 x Ø 10 mm (2x 3 metres)	0.100
19.813	(4) Soft brush (2x)	0.005
19.816	(1) Stand with base and fixing screws (2x)	0.080



MSA	Version	Voltage	Size	Kg
19.807	1 work station	220 V	295 x 200 x 220 mm	8.300
19.807-110	1 work station	110 V	295 x 200 x 220 mm	8.300

System with vacuum. Oil free engine, very noise-less and compatible for use in a white room.

Technical data :
- Flow 2300 litres/hour
- Absolute empty value : 80 mbar
- Pressure 1 bar uninterrupted (maximum 2.8 bar)
- Noise level : 48 dB.

VACUUM FUNCTION

Items delivered with MSA19.807 :

MSA	Item	Kg
19.811	(3) Vacuum pencil (1x)	0.011
19.812	(2) Transparent PVC hose, Ø int. 6 x Ø 10 mm (1x 3 metres)	0.100
19.813	(4) Soft brush (1x)	0.005
19.816	(1) Stand with base and fixing screws (1x)	0.080



MSA	Version	Voltage	Size	Kg
19.820	1 work station	220 V	295 x 200 x 220 mm	9.400
19.820-110	1 work station	110 V	295 x 200 x 220 mm	9.400

System with double function air pressure and vacuum.
Oil free engine, very noise-less and compatible for use in a white room.
One work station with 2 foot switches and 1 recovery bowl.

Technical data :
- Flow 2300 litres/hour
- Absolute empty value : 80 mbar
- Pressure 1 bar uninterrupted (maximum 2.8 bar)
- Noise level : 48 dB.

DOUBLE FUNCTION AIR PRESSURE AND VACUUM

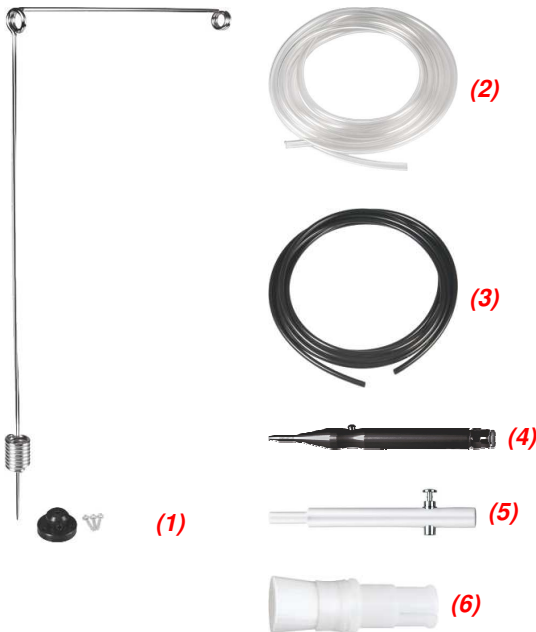

Items delivered with MSA19.820 :

MSA	Item	Kg
19.811	(5) Vacuum pencil (1x)	0.011
19.812	(2) Transparent PVC hose, Ø int. 6 x Ø 10 mm (1x 3 metres)	0.100
19.813	(6) Soft brush (1x)	0.005
19.816	(1) Stand with base and fixing screws (2x)	0.080
19.817	(4) Blower (1x)	0.016
19.826	(3) Black hose, Ø 6x4 mm (1x 1 metre)	0.045

Accessories (regulation and filtration) for MSA19.807, MSA19.808, MSA19.820 and MSA19.850 :

MSA	Item
19.808-P	(1) Pedal for MSA19.807 and 19.808
19.822	(2) Pump filter
19.838	(3) Mini-ball valve 2/2 instant in-line, Ø 10 mm
19.859	(4) Pressure regulateur with manometer and fitting Ø 6 mm

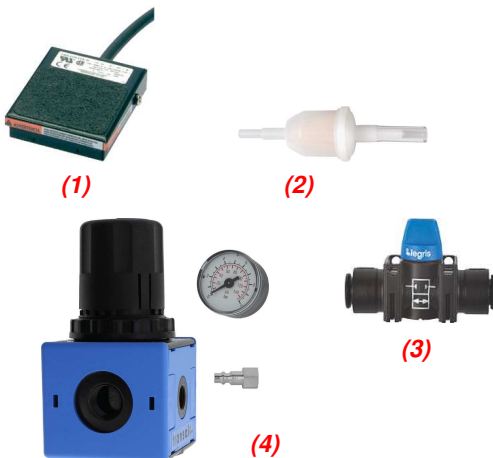

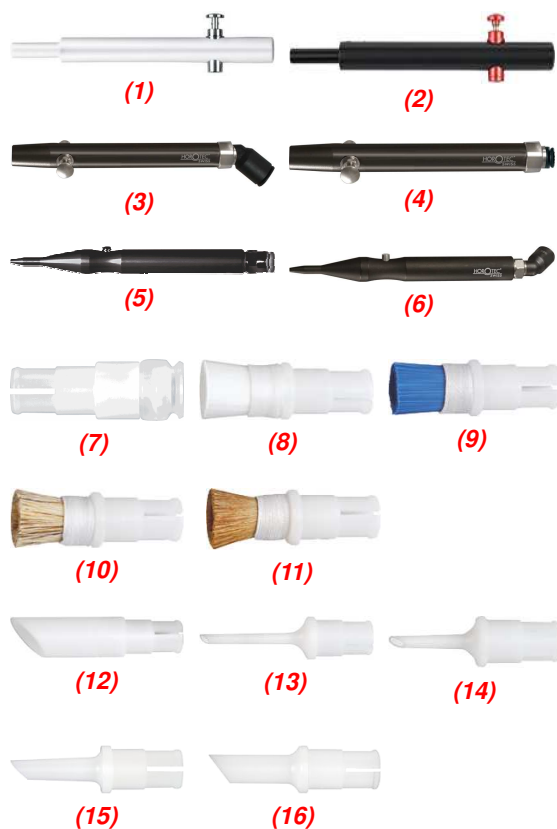

Accessories for vacuum/compressed air devices :

MSA	Item	Kg
19.811	(1) Vacuum pencil, Ø 10 x L90 mm	0.011
19.833	(2) Air proof vacuum pencil for MSA19.850 only	0.015
19.877	(3) Vacuum pencil with fitting 45° for hose Ø 8 mm	0.037
19.878	(4) Vacuum pencil with straight fitting for hose Ø 8 mm	0.038
19.817	(5) Blower	0.016
19.856	(6) Blower with fitting 45°	0.022
19.846-10	(7) Suction end piece for vacuum pencil, Ø 10 mm	0.004
19.846-15	(7) Suction end piece for vacuum pencil, Ø 15 mm	0.004
19.846-20	(7) Suction end piece for vacuum pencil, Ø 20 mm	0.004
19.846-25	(7) Suction end piece for vacuum pencil, Ø 25 mm	0.005
19.813-A	(8) Soft brush white nylon, Ø 6 mm	0.005
19.813	(8) Soft brush white nylon, Ø 10 mm	0.005
19.823	(8) Soft brush white nylon, Ø 15 mm	0.005
19.867	(8) Soft brush white nylon, Ø 25 mm	0.005
19.868	(8) Soft brush white nylon, Ø 35 mm	0.005
19.814	(9) Hard brush blue nylon, Ø 10 mm	0.005
19.814-A	Soft brush blue nylon, Ø 6 mm	0.005
19.847	Very hard brush red nylon, Ø 10 mm	0.005
19.825	(10) Badger-hair brush, Ø 10 mm	0.005
19.825-15	(10) Badger-hair brush, Ø 15 mm	0.005
19.819	(11) Marten-hair brush, Ø 10 mm	0.005
19.832	(11) Marten-hair brush, Ø 15 mm	0.005
19.821	(12) Beak 45° with nylon filter	0.006
19.824	(13) Thin long beak 25 mm, Ø 2.3 mm	0.004
19.824-A	(14) Thin short beak, Ø 2.3 mm x L15 mm	0.003
19.824-C	Thin long elbow 45° beak, Ø 2.3 mm x L45.20 mm	0.004
19.829	(15) Medium short beak, Ø 4 mm x L15 mm	0.003
19.829-A	(16) Medium short beak, Ø 6 mm x L15 mm	0.003

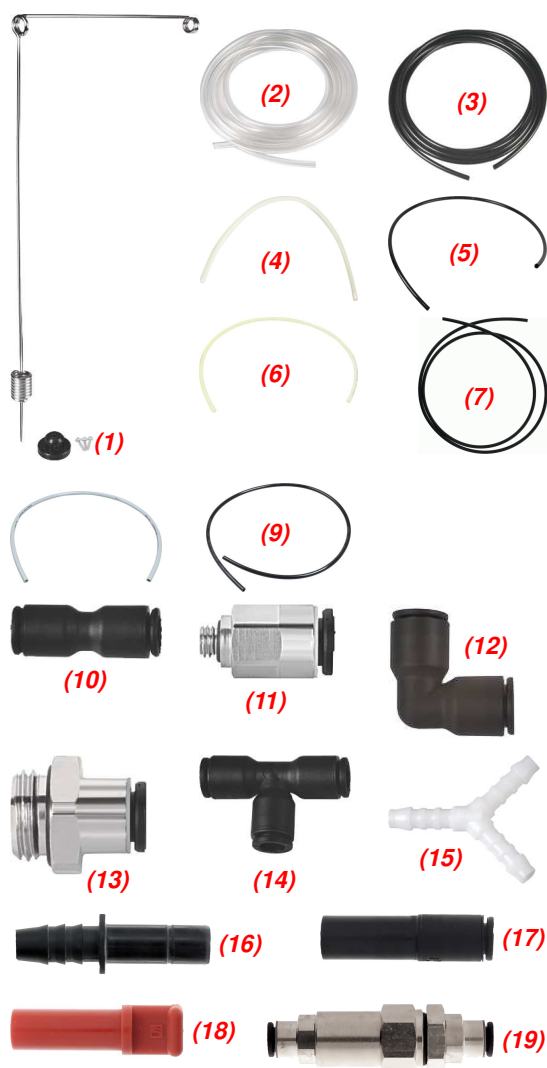

Connections for vacuum/compressed air devices :

MSA	Item	Kg
19.816	(1) Stand with base and fixing screws	0.080
19.812	(2) Transparent PVC hose, Ø int. 6 x Ø 10 mm x 1 metre	0.100
19.826	(3) Black hose, Ø 6x4 mm x 1 metre	0.045
19.834	(4) Transparent hose, Ø 14x12 mm x 1 metre	0.030
19.840	(5) Soft black PVC hose, Ø 10x7 mm x 1 metre	0.022
19.841	(6) Semi-rigid white polyamide hose, Ø 4x2.7 mm x 25 metres	0.046
19.842	(7) Soft black PVC hose, Ø 4x2.5 mm x 1 metre	0.013
19.848	(8) Soft grey hose, Ø 12x8 mm x 1 metre	0.090
19.851	(9) Black hose, Ø int. 5.5 x Ø 8 mm x 1 metre	0.040
19.828-A	(10) Straight fitting, Ø 6 mm	0.005
19.828-B	(10) Straight fitting, Ø 10 mm	0.005
19.830	(11) Straight male fitting D6 for blower, M5	0.005
19.830-B	(12) 90° angle fitting, Ø 10 mm	0.006
19.830-D	(12) 90° angle fitting, Ø 14 mm	0.015
19.830-G1/4	(13) Quick fitting G 1/4, Ø 6 mm	0.010
19.827-A	(14) "T" fitting, Ø 6 - 6 - 6 mm	0.005
19.827-B	(14) "T" fitting, Ø 10 - 10 - 10 mm	0.011
19.827-C	(14) "T" fitting, Ø 14 - 14 - 14 mm	0.008
19.827-D	(14) "T" fitting, Ø 12 - 12 - 12 mm	0.022
19.815	(15) "Y" fitting, Ø 6 mm	0.005
19.877-R	(16) Fitting for vacuum pencils MSA19.877/19.878 (for hose MSA19.812)	0.002
19.839-A	(17) Reducer, 10-6 mm	0.003
19.839-B	(17) Reducer, 14-10 mm	0.006
19.839-C	(17) Reducer, 12-6 mm	0.006
19.835-A	(18) Hose plug Ø 6 mm	0.001
19.835-B	(18) Hose plug Ø 10 mm	0.002
19.835-C	(18) Hose plug Ø 14 mm	0.006
19.835-D	(18) Hose plug Ø 12 mm	0.004
19.811-F	Intermediate filter for vacuum brush	0.005
19.873	(19) In-line filter for compressed air with straight fittings Ø 6 mm	0.054